

Quick-Connect Guide

DTX-5000

Home Theater in a Box

home theater

YAMAHA

Yamaha created this package to greatly enhance your audio and home theater enjoyment. This Quick-Connect Guide will help you get started. Follow the steps to assemble and connect the speakers first. Refer to your Owner's Manuals as well as those that came with your other components for complete instructions and precautions. Be sure to turn off all power while making connections. You will need the following which are not included in the package: Phillips screwdriver, wire cutter/stripper, toggle bolts, molly anchor screws or sheet metal screws.

1 In the Box



Inspect Contents After unpacking, inspect the contents to confirm you have the above items: 1 two main speakers, 2 three rear speakers, 3 one center speaker, 4 speaker wire, 5 two bases, 6 two speaker stands, 7 two finishing brackets, 8 RCA cable, one bag each of 9 long screws (8) and 10 short screws (4), 11 center speaker bracket and screw, 12 subwoofer, 13 non-skid pads for base, 14 non-skid pads for stands, 15 cable protection seal for base, 16 audio/video RCA cable, 17 HTR-5750 Receiver with remote, 18 and DV-S5770 DVD Player with remote, and 19 optical cable. Also included, but not shown, are AM and FM antennas and three related Owner's Manuals.

2 Room Layout

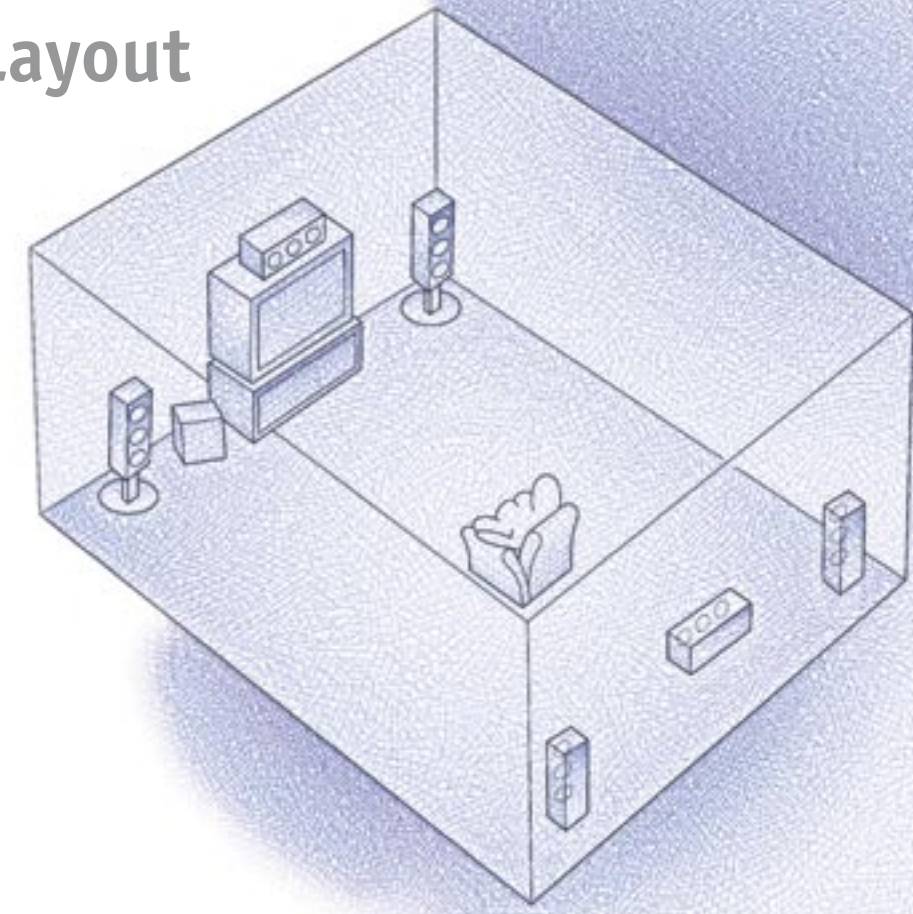

Speaker Placement After assembly of the speakers place them so they appear in the approximate positions as shown in the diagram above.

3

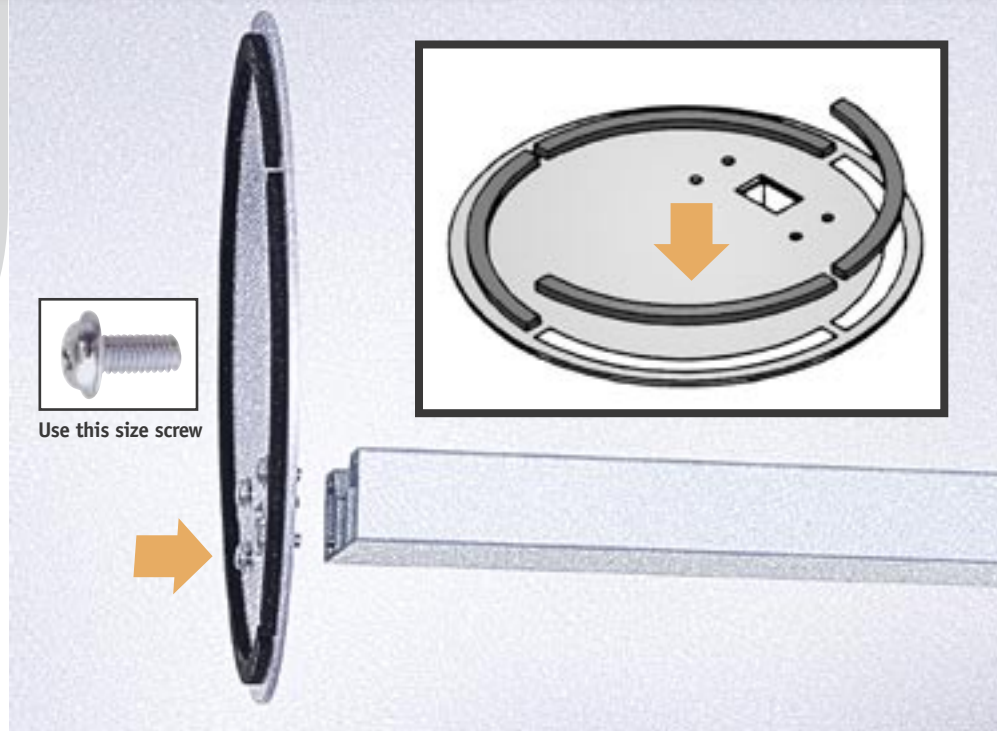

Main Speaker Assembly

Attach Bases to Stands Apply the non-skid pads 13 as shown in the inset. Identify both speaker stands 6 and both bases 5 and attach using short screws 10 as shown.

4

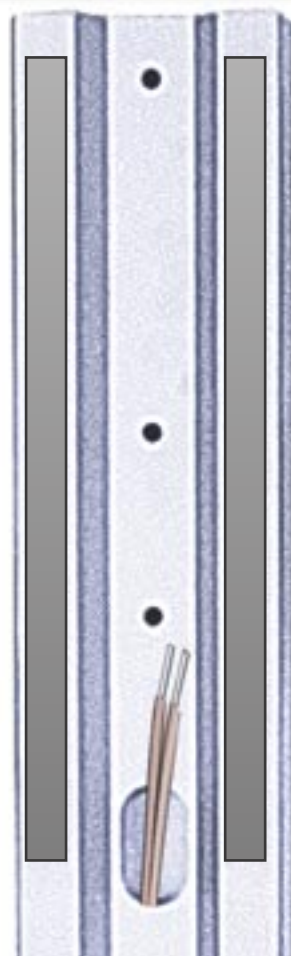

Thread Speaker Wires Cut speaker wire 4 to appropriate lengths for all speaker connections and set aside. Place each long stand upright on its base. Thread main speaker wire through oval opening on stand and pull through opening on underside of base. Pull wire all the way through leaving extra length near oval opening as shown. Apply non-skid pads 14 on stands.

5

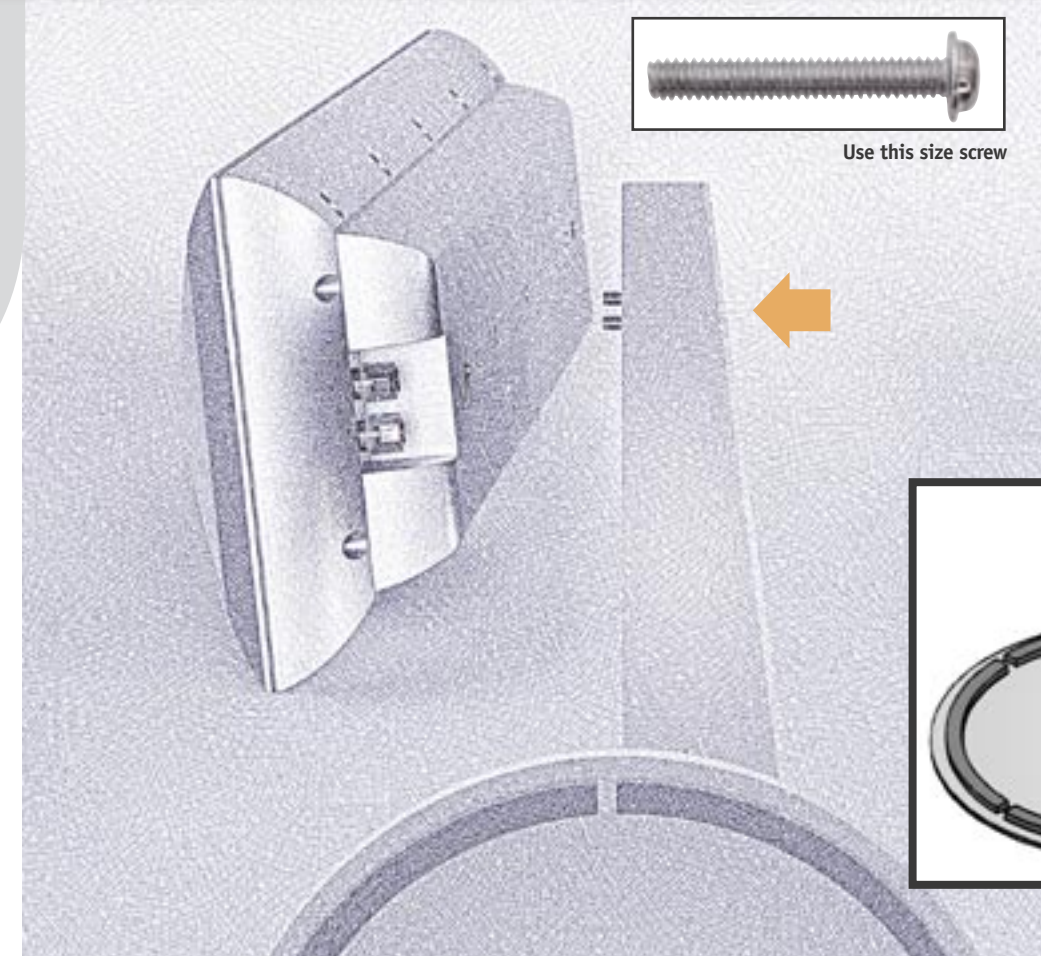

Attach Main Speakers Lay stands down. Line up holes so that oval opening is near speaker wire connections on speaker. Attach main speakers using long screws as shown. Attach cable protection seal 15 to base as shown in inset.

6

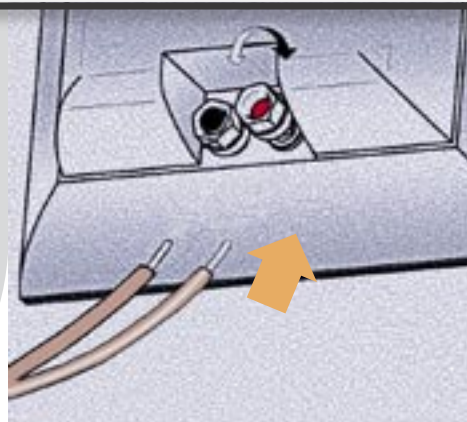

Connect Main Speaker Wire For illustration purposes, stand, which is now attached to speaker, is not shown in diagram above. Locate screw-type input terminals at the rear of each of the speakers. Connect the speaker wire as shown. The positive (+) side of the wire with the white stripe attaches to the red terminal. The negative (-) side attaches to the black terminal. (Please see your NS-FP9500 Owner's Manual for more detailed instructions on speaker wire connections.) Place assembled main speakers in desired location to the left and right of the viewing/audio source. (See Step 2, Room Layout.)

NOTE Banana plug connectors (not included) can be used to connect speaker wire to speaker terminals. Please see your Owner's Manual for directions.

7

Rear Speakers

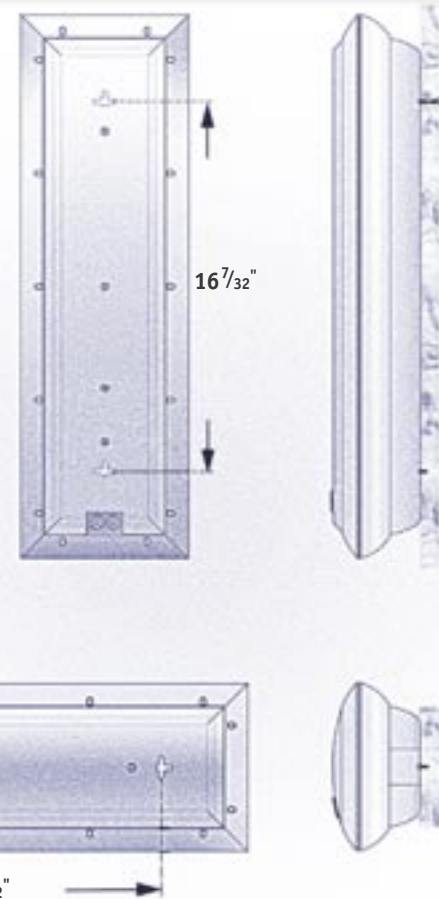

For mounting screws, use minimum 1 3/4" tapping screw (not included). Leave 1/4" space between screw head and wall.

Mount Rear Speakers and Rear Center Speaker (Optional) Fasten mounting screws into a firm wall or wall support as shown. Hang the keyholes on the back of the each of the speakers 2 on the protruding screws. Attach speaker wire as shown in Step 6.

WARNING If you are unsure of how to securely and safely fasten speakers to a wall, please contact a reliable source about the best type of hardware for your particular wall's construction. Secure installation is the purchaser's responsibility. See Owner's Manual for additional instructions and precautions.

8

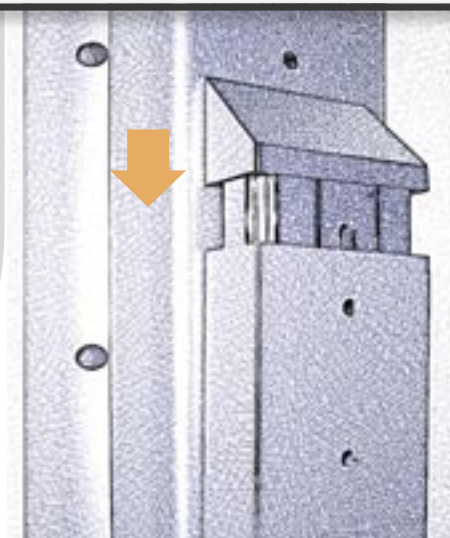

Attach Finishing Brackets 7 on top of two speaker stands.

9

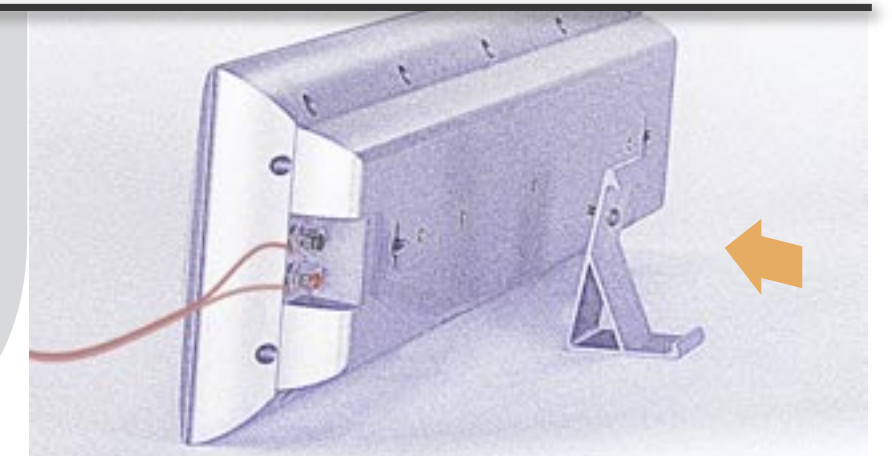

Center Speaker Assembly

Attach Bracket and Speaker Wire Attach bracket 11 to center speaker 3 using supplied screw as shown. Attach speaker wire as shown in Step 6.

10

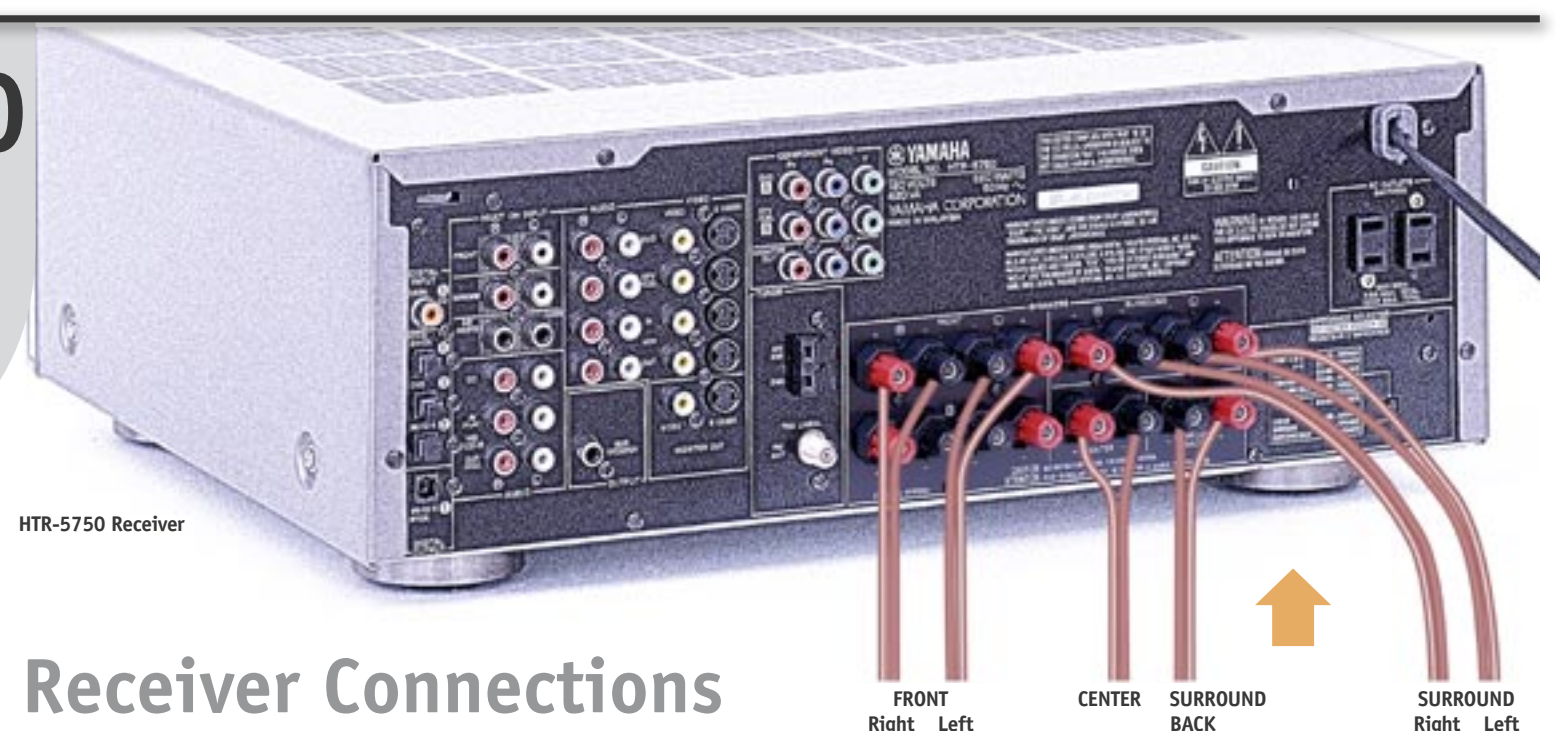

Receiver Connections

Connect Speakers Positive (+) side of the wire with white stripe attaches to (+) terminal. Negative (-) side attaches to (-) terminal.

CAUTION Receiver must not be plugged in while connecting speakers.

11

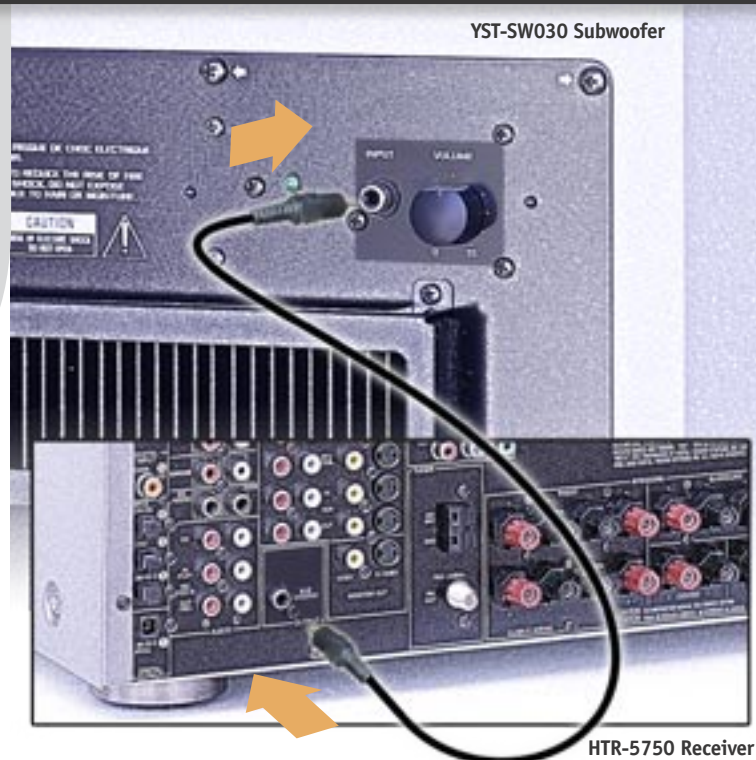

Subwoofer Connection

Connect RCA Cable Connect RCA cable 8 to subwoofer. Set subwoofer VOLUME control to half-way mark and POWER to OFF. Connect RCA cable to receiver from subwoofer.

WARNING Components must not be plugged in while connecting them. Wait until all connections are made before plugging in your components.

12

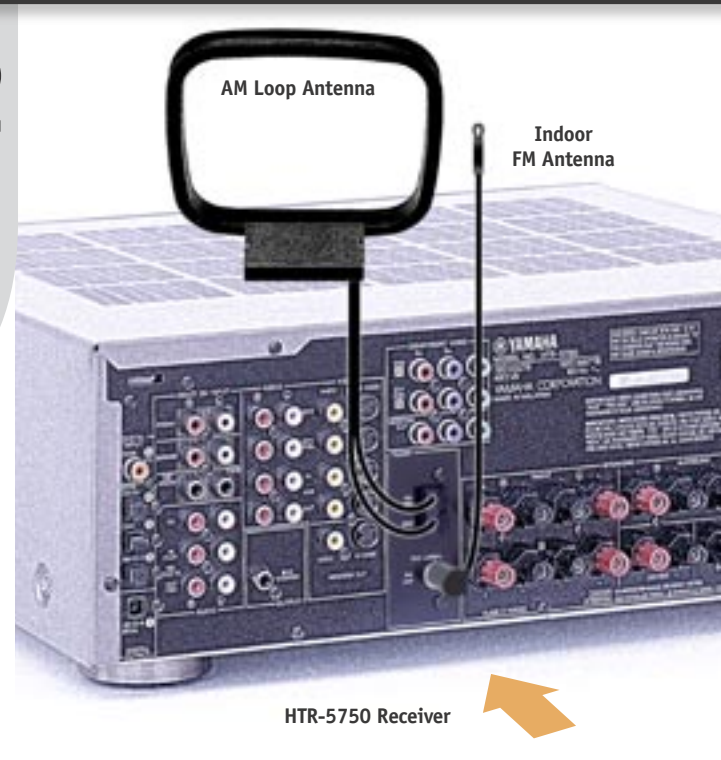

Antenna Connection

Connect Antennas to Receiver Locate AM loop antenna and indoor FM antenna. Keeping receiver unplugged, connect as shown. For more information about obtaining clear reception and grounding, see your Owner's Manual.

13

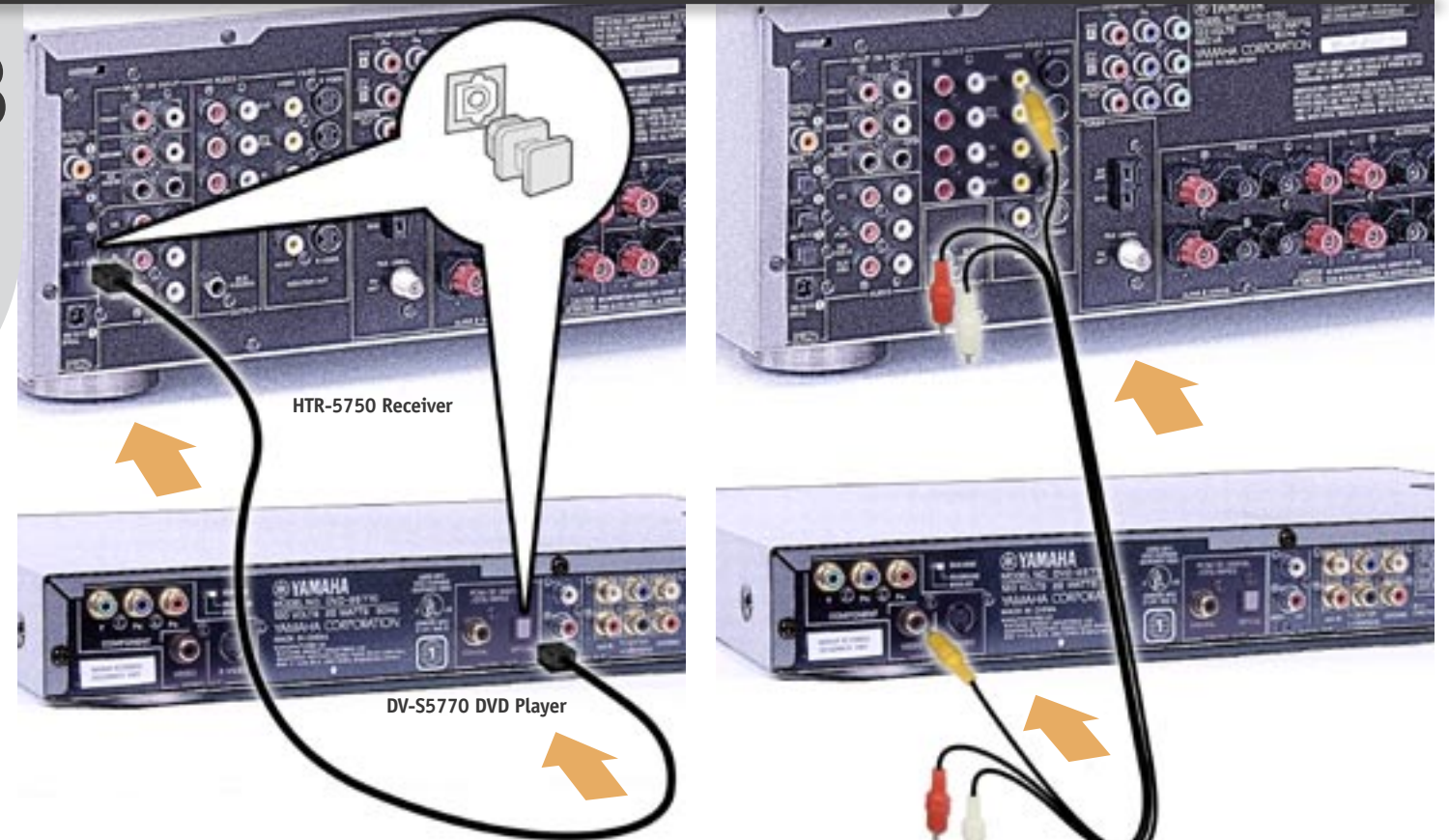

DVD Player Connection

DVD Player Optical Connection Remove dust cap on optical input as shown on insets. Connect optical cable 10 to receiver. Connect optical cable to DVD player from receiver.

DVD Player Video Connection

Top: Connect RCA video cable 9 to receiver: Yellow to "DVD," as shown, and leave White and Red unplugged. Bottom: Connect video cable to DVD player from receiver: Yellow to "Video," as shown, and leave White and Red unplugged.

14

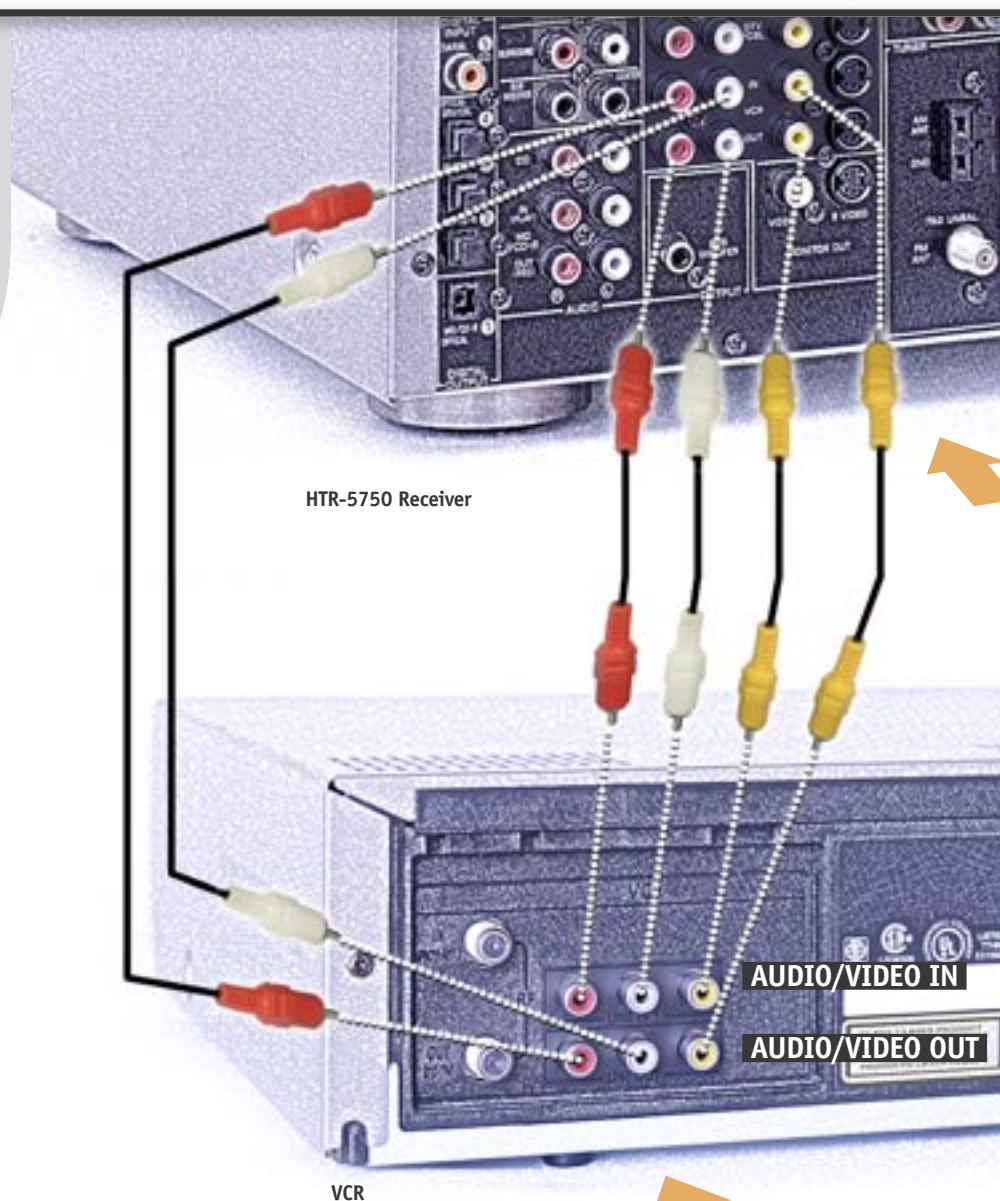

VCR Connection

Connect VCR (optional) Connect audio/video cables (not included) as shown.

NOTE VCR shown is for illustration purposes only. When using a hi-fi stereo VCR, set the Tuner/Line switch on the VCR to "Line" position to record from another source connected to the HTR-5750 receiver.

15

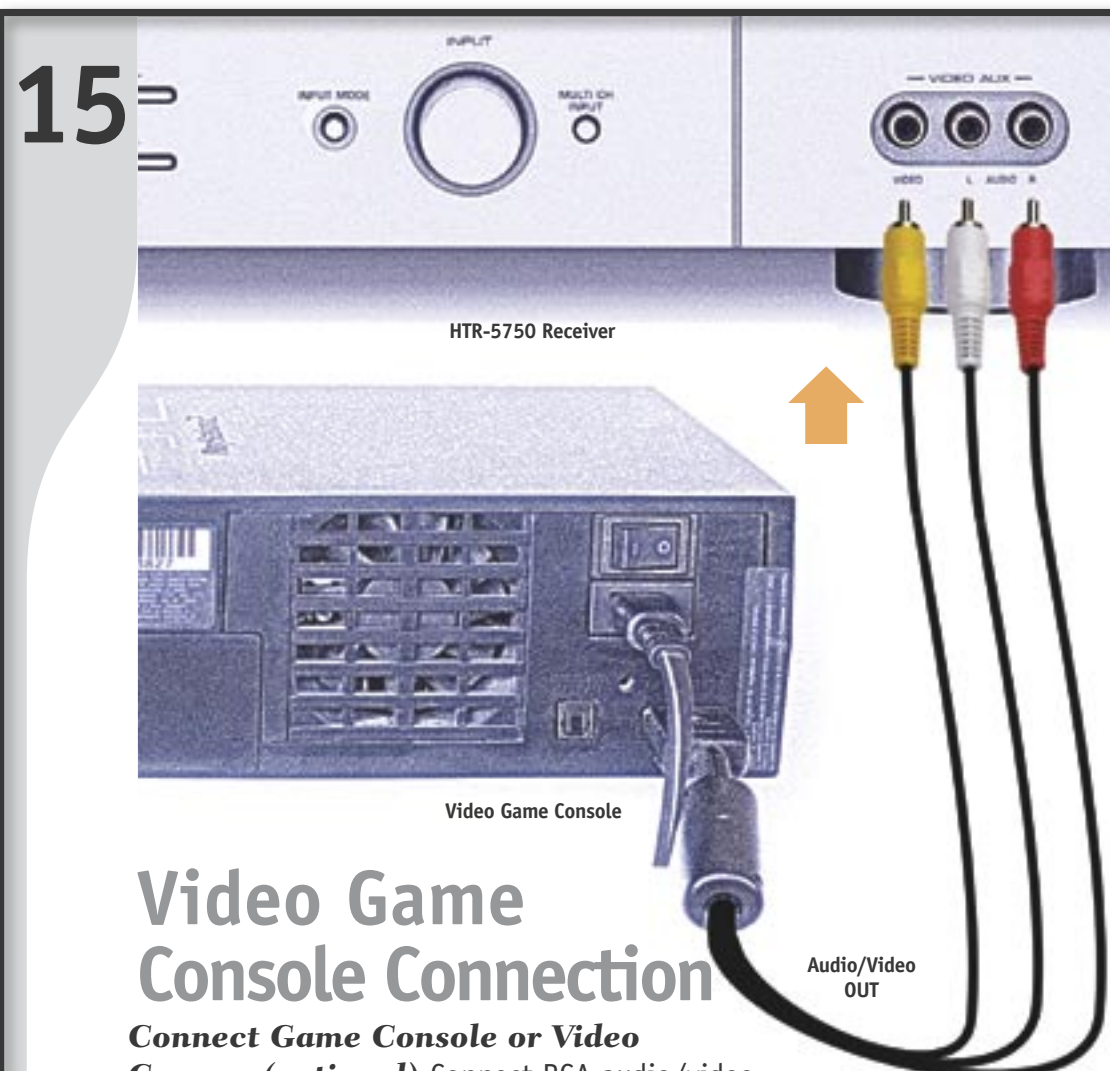

Video Game Console Connection

Connect Game Console or Video Camera (optional) Connect RCA audio/video cables (not included) as shown.

16

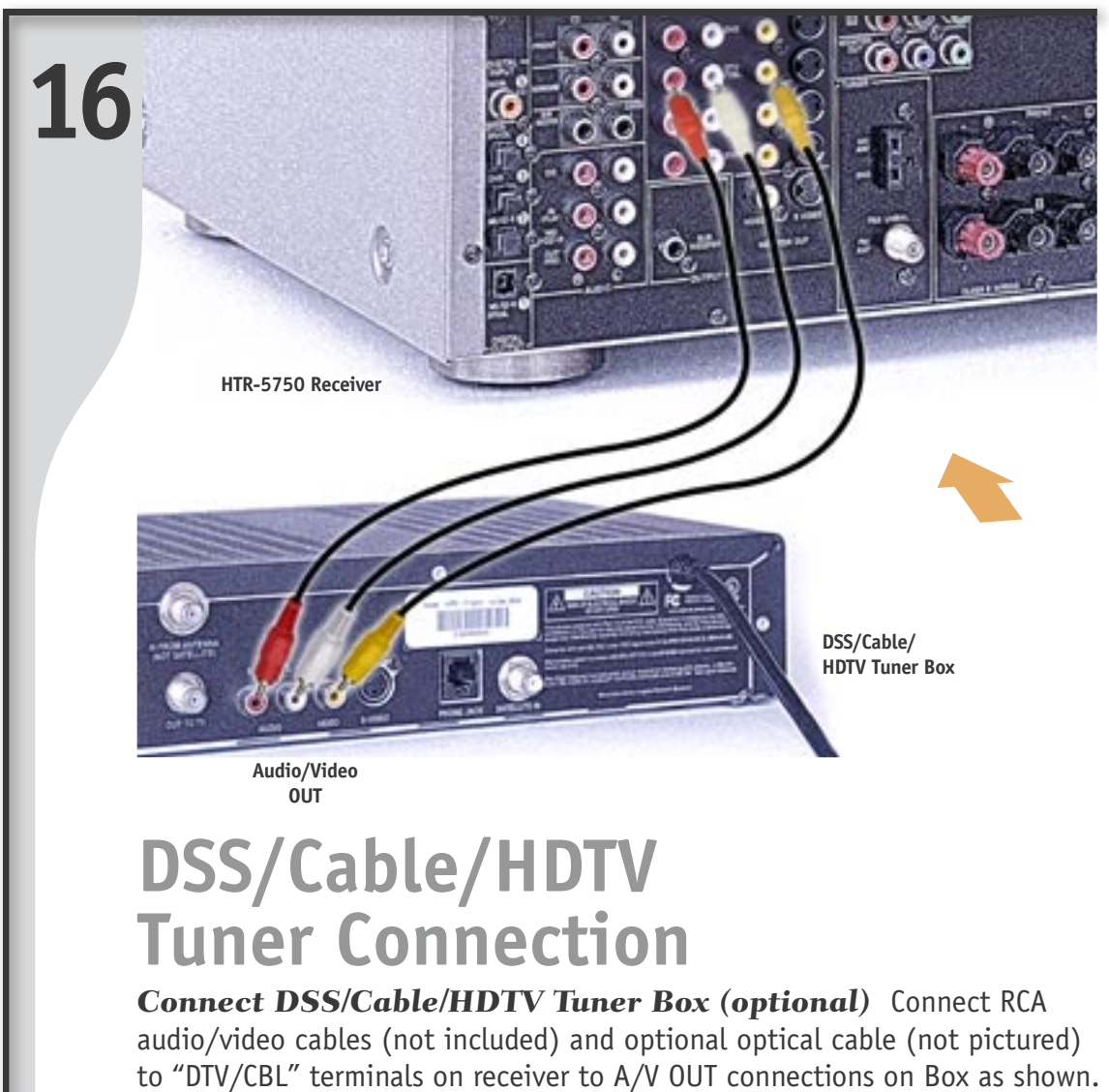

DSS/Cable/HDTV Tuner Connection

Connect DSS/Cable/HDTV Tuner Box (optional) Connect RCA audio/video cables (not included) and optional optical cable (not pictured) to "DTV/CBL" terminals on receiver to A/V OUT connections on Box as shown.

17

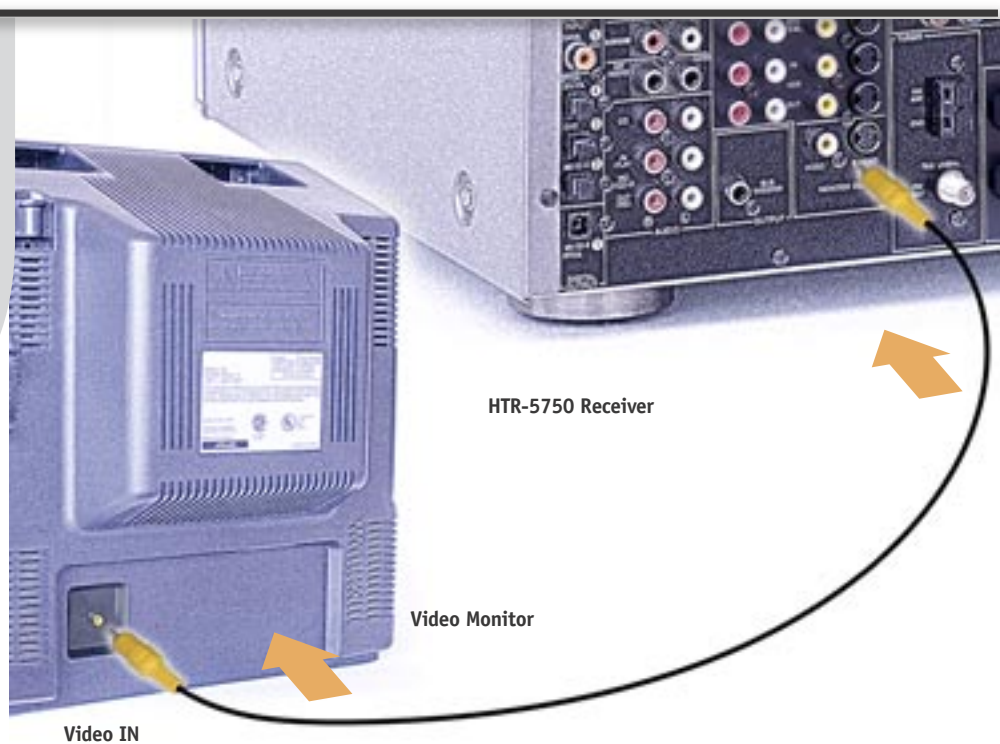

Video Monitor Connection

Connect a Video Monitor Connect an RCA video cable (not included) to receiver Monitor OUT from your video monitor as shown.

18

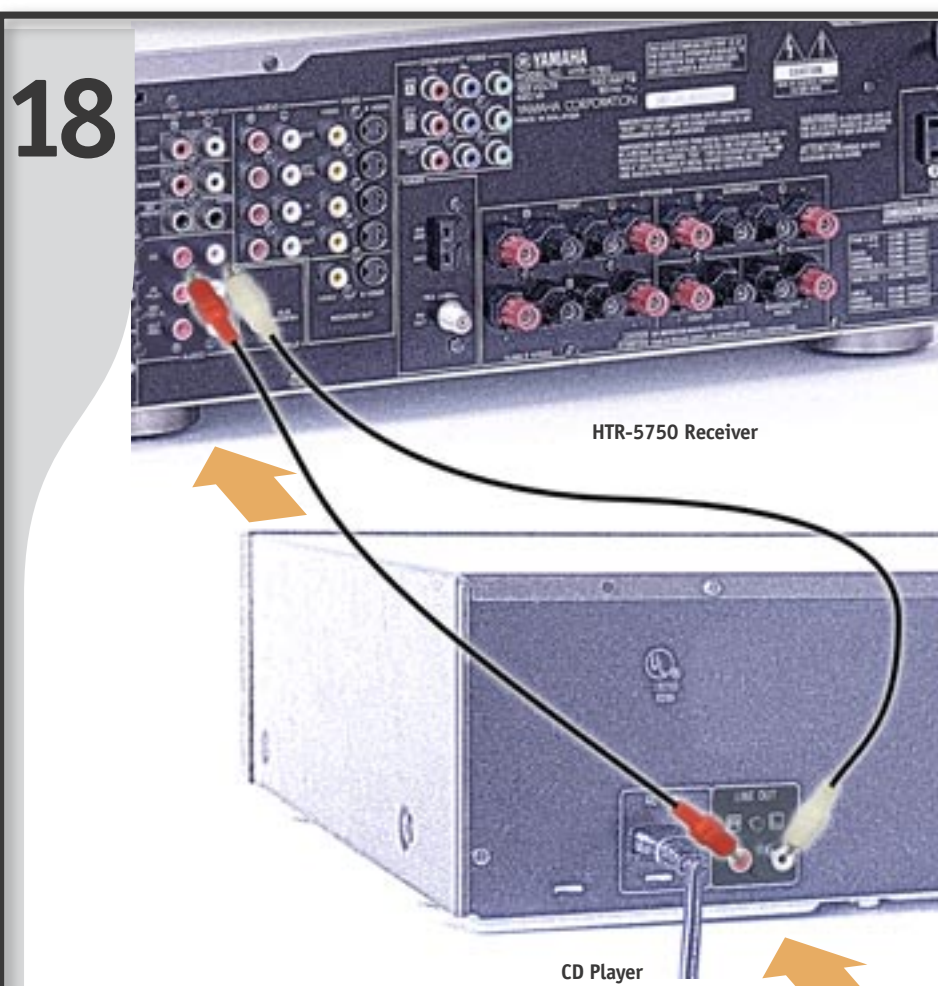

CD Player Connection

Connect CD Player (optional) Connect RCA audio cables (not included) to "CD" terminals on receiver as shown. If your CD Player has digital output terminal, connect digital cable (not included) to HTR-5750 Receiver Digital Input terminal. See page 17 of your HTR-5750 Owner's Manual for more information.

19

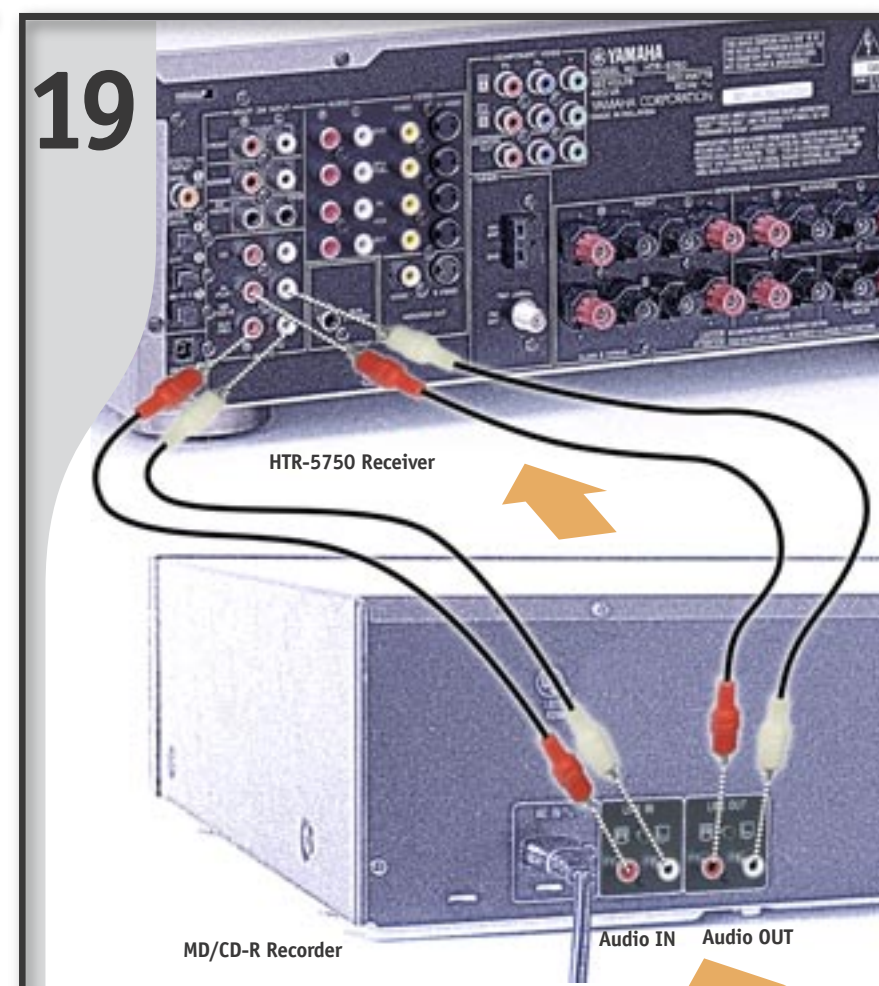

MD/CD-R Player Connection

Connect MD/CD-R Recorder (optional) Connect RCA audio cables (not included) to "MD/CD-R" terminals on receiver as shown.

20



Plug In Plug in the subwoofer, receiver, DVD player and other components. Power on the receiver first, then the subwoofer, and the others next. Adjust volume on the receiver. Please see each of your respective Owner's Manuals for recommended guidelines and settings.



Enjoy the Yamaha Home Theater Experience
Be sure to put batteries in your remotes (see Owner's Manuals for instructions). Refer to your Owner's Manuals for each component in your system for more information. Now, relax and enjoy the unparalleled sound of your Yamaha Home Theater system.

YAMAHA ELECTRONICS CORPORATION, USA
6660 Orangethorpe Avenue
Buena Park, CA 90620
<http://www.yamaha.com>
Phone: 1-800-292-2982

©2004 Yamaha Electronics Corporation
Printed in USA