

# YAMAHA SBS-100 Quick Start Guide

## Supplied items

Before assembling and connecting, make sure you have received all of the following items. If anything is missing, please call 888-892-6242, 8AM to 5PM PST Monday through Friday.

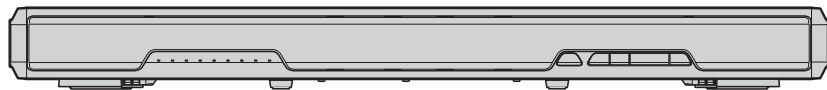

Unit (SBS-100)



Remote control

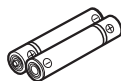

Two AAA batteries  
(Install the batteries in the remote control.)



Optical cable  
1.5 m (4.9 ft)

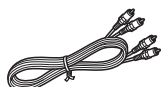

RCA stereo cable  
1.5 m (4.9 ft)



Owner's Manual



Quick Start Guide  
(This sheet)

## Preparing the remote control

Peel off the protection sheet before use.

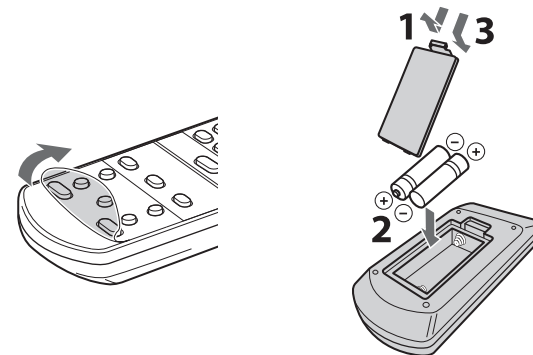

## Placement

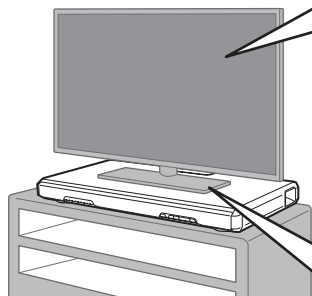

### TVs that can be placed on the unit:

- TVs weighing 40 kg (88.1 lbs) or less
- TVs with a base width 750 mm (29-1/2") or less
- TVs with a base depth 340 mm (13-3/8") or less
- Flat-screen TV's with a screen size 55 inches or less

### The base of a TV should be centered on the top of the unit.

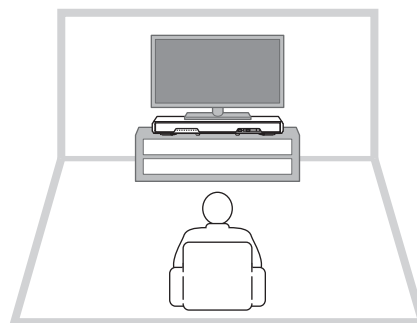

- Keep a distance of more than 2 meters (6.6 ft) between the unit and listener.
- Install the unit in front of the listening position.
- If the sound beams are blocked by obstacles such as furniture, adjust the position of the unit or the obstacles.

Place the unit on a flat surface such as on top of a TV cabinet, and then place a TV on top of the unit.

### NOTE

- Do not place any device other than a TV on the unit. For details, refer to the Owner's Manual.
- Never fix the unit to a wall or other surface using a fall prevention device, such as wire or bracket, supplied with the TV. Doing so may cause the unit fall together with the TV if an accident such as an earthquake occurs. For details, refer to the instruction manual of your TV.

Continued to the reverse side



## Connections

1. Remove the jack cover on the top panel of the unit.
2. Connect the TV and unit with the optical cable (supplied).

Remove the cap of the optical cable and check the direction of the plug.



3. Connect the power cable of the unit to an AC wall outlet.

Connect to an AC wall outlet. Leave the unit powered off until all connections are complete.

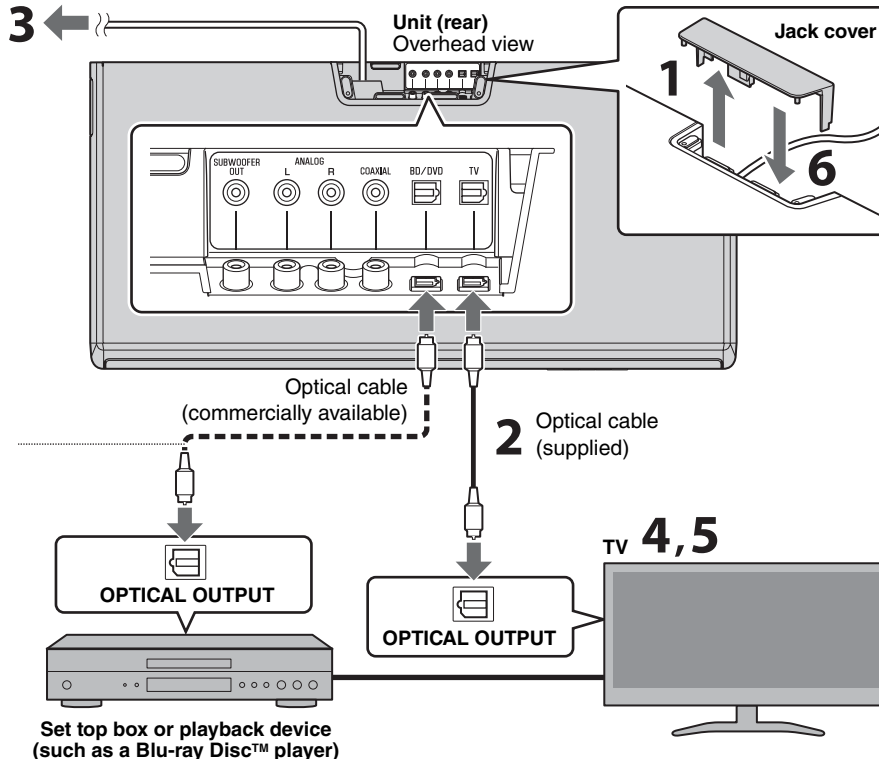

### HINT

In the following cases, connect the optical output of the playback device to the BD/DVD input of the unit with an optical cable (commercially available), then select the BD/DVD key on the remote control for the input source.

- The TV does not have an optical output.
- The TV does not output audio (or outputs low volume audio) from the connected playback device.
- The audio from the playback device connected to the TV cannot be heard as surround sound.

4. Turn on the TV and set the volume to minimum.
5. Disable the TV speakers using the TV's audio settings menu (if available).
6. Attach the jack cover.

### HINT

If a setting to disable the speaker output is not available on your TV, you may disable it by connecting headphones to the headphone jack on the TV. For details, refer to the instruction manual of the TV.

## SBS position

For optimum surround effect, perform the following to set the SBS POSITION according to the installation position of the unit. For details, refer to the Owner's Manual.

1. Hold down the SBS POSITION key on the remote control that corresponds to the installation position of the unit for more than 3 seconds.

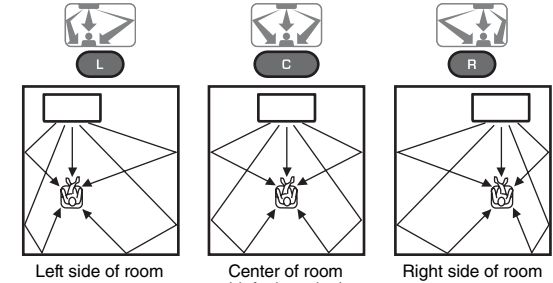

## Watching TV

For details, refer to the Owner's Manual.

1. Press to turn on the unit.
2. Press the TV key to select TV as the input source.
3. Select the desired input source on the TV.
4. Press the VOLUME (+/-) keys to adjust the volume.

## ... and more features!

For details about the other useful features, refer to the Owner's Manual.

- Playback of a Bluetooth® device
- TV remote control learning function
- Clear voice
- UniVolume

The Bluetooth® word mark and logos are registered trademarks owned by Bluetooth SIG, Inc. and any use of such marks by Yamaha Corporation is under license.

Blu-ray Disc is a trademark of the Blu-ray Disc Association.